

IMPORTANT SAFETY INFORMATION

Read and understand all safety precautions and instructions before use.
 The Metal Handled Brush Grubber is designed for outdoor use only.
 Check Metal Handled Brush Grubber before each use for signs of wear or damage.
 Do Not use if there is any damage or if not working properly.
 The Metal Handled Brush Grubber is designed to remove brush up to 1.5" diameter
 The Metal Handled Brush Grubber is not to be used on people or pets.



Figure 1

INSTRUCTIONS

1. Lift the lever upward on the handle of the Metal Handled Brush Grubber to open Jaws. Be sure to pull lever all the way up so that the Jaws stay open.
 2. Position the Metal Handled Brush Grubber with one grip pad on each side of the brush or small tree with lift leverage stand on ground.
 3. Release the lever downward to close the jaws and grip the brush/tree.
 4. Pull handle downward to extract brush/tree.
 5. Lift the lever upward on the handle to release the brush/tree.
- See parts breakdown on back page.

Take caution of all pinch points on the Metal Handled Brush Grubber.
NEVER use any additional tools for added force.

PARTS DESCRIPTION

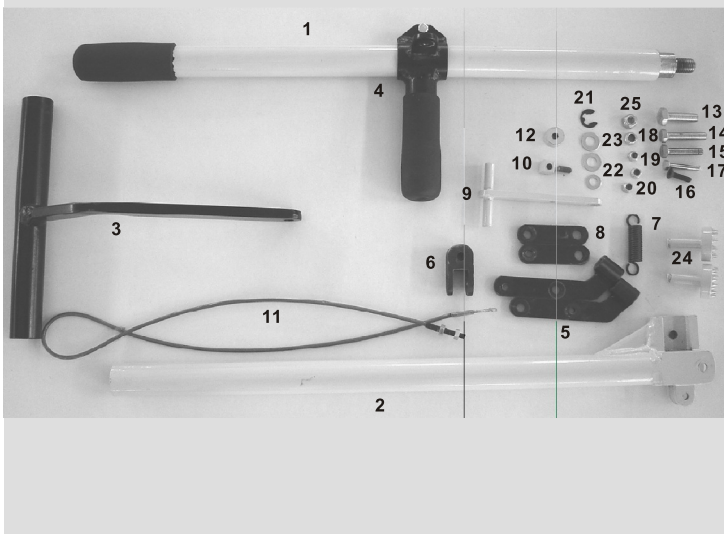

| Ref. # | Qty | Part # | Description |
|--------|-----|---------|------------------------------------|
| 1 | 1 | BG02-01 | Back Handle |
| 2 | 1 | BG02-02 | Front Handle |
| 3 | 1 | BG02-03 | Lift Leverage Stand |
| 4 | 1 | BG02-04 | Side Grip Handle |
| 5 | 2 | BG02-05 | Main Arm |
| 6 | 1 | BG02-06 | Connector |
| 7 | 1 | BG02-07 | Spring \varnothing 14x68mm |
| 8 | 2 | BG02-08 | Clevis Arm |
| 9 | 1 | BG02-09 | Locking Lever |
| 10 | 1 | BG02-10 | Square Bolt M6 |
| 11 | 1 | BG02-11 | Wire Cable \varnothing 2.5x930mm |
| 12 | 1 | BG02-12 | Roller |
| 13 | 1 | BG02-13 | Hex bolt M10x35 |
| 14 | 4 | BG02-14 | Hex bolt M8x50 |
| 15 | 1 | BG02-15 | Hex bolt M6x35 |
| 16 | 1 | BG02-16 | Bolt M10x40 |
| 17 | 2 | BG02-17 | Hex bolt M6x25 |
| 18 | 3 | BG02-18 | Nut M8 |
| 19 | 4 | BG02-19 | Lock Nut M8 |
| 20 | 4 | BG02-20 | Lock Nut M6 |
| 21 | 3 | BG02-21 | E-Clip \varnothing 13 |
| 22 | 4 | BG02-22 | Washer \varnothing 8 |
| 23 | 14 | BG02-23 | Washer \varnothing 13 |
| 24 | 2 | BG02-24 | Grip Pad |
| 25 | 2 | BG02-25 | Lock Nut M10 |



WARNING

BAC Industries, Inc. and Brush Grubber will not be held liable for any damages, losses or injury due to the misapplication or misuse of this product or any other reason. Always wear approved safety glasses, protective clothing, and proper hand and foot protection at all times. Keep all people, pets, or animals clear from brush removal work area.

Brushgrubber.com
 PO BOX 5064
 HOPKINS, MN 55343

PH: 952-945-9058
 www.brushgrubber.com
 Email: info@brushgrubber.com