

Important Safety Information

Read and understand all safety precautions and instructions before use.

- The Original Brush Grubber Hitch Attachment is designed for outdoor use.
- Check Original Brush Grubber Hitch Attachment before each and every use for signs of wear. Do Not use if damaged or if not working properly
- The Original Brush Grubber Hitch Attachment is designed to use with ATV & UTV receiver hitches. Easily adapts to your existing Original Brush Grubber (Model BG-01) for fast one person operation
- The Original Brush Grubber Hitch Attachment is not to be used on people or pets.



Instructions

1. Pull rope to open the jaws on the BG-01HA Hitch Attachment. Detent will hold the jaws open until released.
2. Back up/pull forward until the brush/stump is in-between the grip pads of the BG-01 Original Brush Grubber
3. Pull the rope to release the detent allowing the jaws to close on the brush/stump.
4. Pull forward/back up to pull the brush/stump, including the root system, out of the ground.
5. Pull the rope again to release the brush/stump from the jaws of the Original Brush Grubber.

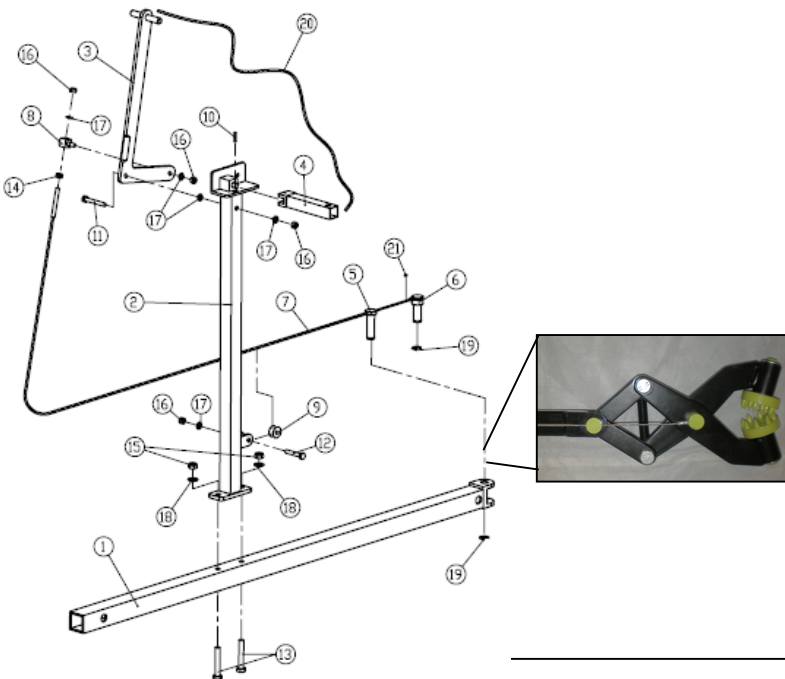

Ref. #	Qty	Part #	Description
1	1	BG-01A-01	Joint Staff
2	1	BG-01A-02	Joint Staff
3	1	BG-01A-03	Handle
4	1	BG-01A-04	Spanner
5	1	BG-01A-05	Center Shaft
6	1	BG-01A-06	Center Shaft
7	1	BG-01A-07	Wire Cable
8	1	BG-02-09	Square Bolt M6
9	1	BG-02-06	Roller
10	1	GB/T879.2	Roll Pins 3*16
11	1	GB/T5782-2000	Hex Bolt M6*45*20
12	1	GB/T5783-2000	Hex Bolt M6*35
13	2	GB/T5782-2000	Hex Bolt M8*50*25
14	1	GB/T6170-2000	Nut M6
15	2	GB/T889.1-2000	Lock Nut M8
16	4	GB/T889.1-2000	Lock Nut M6
17	5	GB/T95-1985	Washer φ6*12*0.5
18	2	GB/T95-1985	Washer φ8*16*1
19	2	GB896-86	E-clip φ9
20	1		Nylon Line φ7

WARNING



BAC Industries, Inc. and Brush Grubber will not be held liable for any damages, losses, or injury, due to misapplication or misuse of this product or for any other reason. Always wear approved safety glasses, protective clothing, and proper hand and foot protection at all times. Keep all people and pets or animals clear from brush removal work area.

BrushGrubber.com
PO BOX 5064
HOPKINS, MN

PH: 952-938-9058
www.brushgrubber.com
Email:

See other unique items at BrushGrubber.com

FOR ANY QUESTIONS, PLEASE CONTACT OUR OFFICE OR VISIT WWW.BRUSHGRUBBER.COM